

Introduction

1. This Map Portfolio accompanies the Basildon District Local Development Framework Call for Sites Schedule of Submissions document (Ref CS-CFS1).
2. Its purpose is to help identify which parcels of land in the District were put forward during the first Call for Sites in autumn 2007.

Using the Map Portfolio

3. We would recommend using the Schedule first. It sets out the sites which were submitted by Site Reference Number (e.g. CFS 001) and Address, etc. The Map Reference column indicates which map(s) to look at to see its location and boundary.
4. In turn, each site displayed on the maps is labelled with its unique Site Reference Number. In most cases this is either within or next to the site itself.

Site Capture

5. Most sites are drawn as a red-dashed line around their extent.

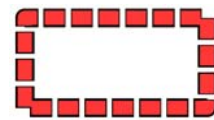

However, due to the number and complexity of some submissions in parts of the District, it has been necessary to use other line styles and colours to distinguish each site submission. These have been cross-referenced individually in the legend of each map.

6. There are some cases however (e.g. Map 4) which due to the size of the sites and map scale have caused problems with site labelling. In these cases, the sites have been identified in different line styles or patterns and displayed separately in the legend.

Contact Information

7. The Forward Plans Team can be contacted on any matter concerning the Local Development Framework, including the Call for Sites.

Email: ldf@basildon.gov.uk;
Telephone: 01268 294748





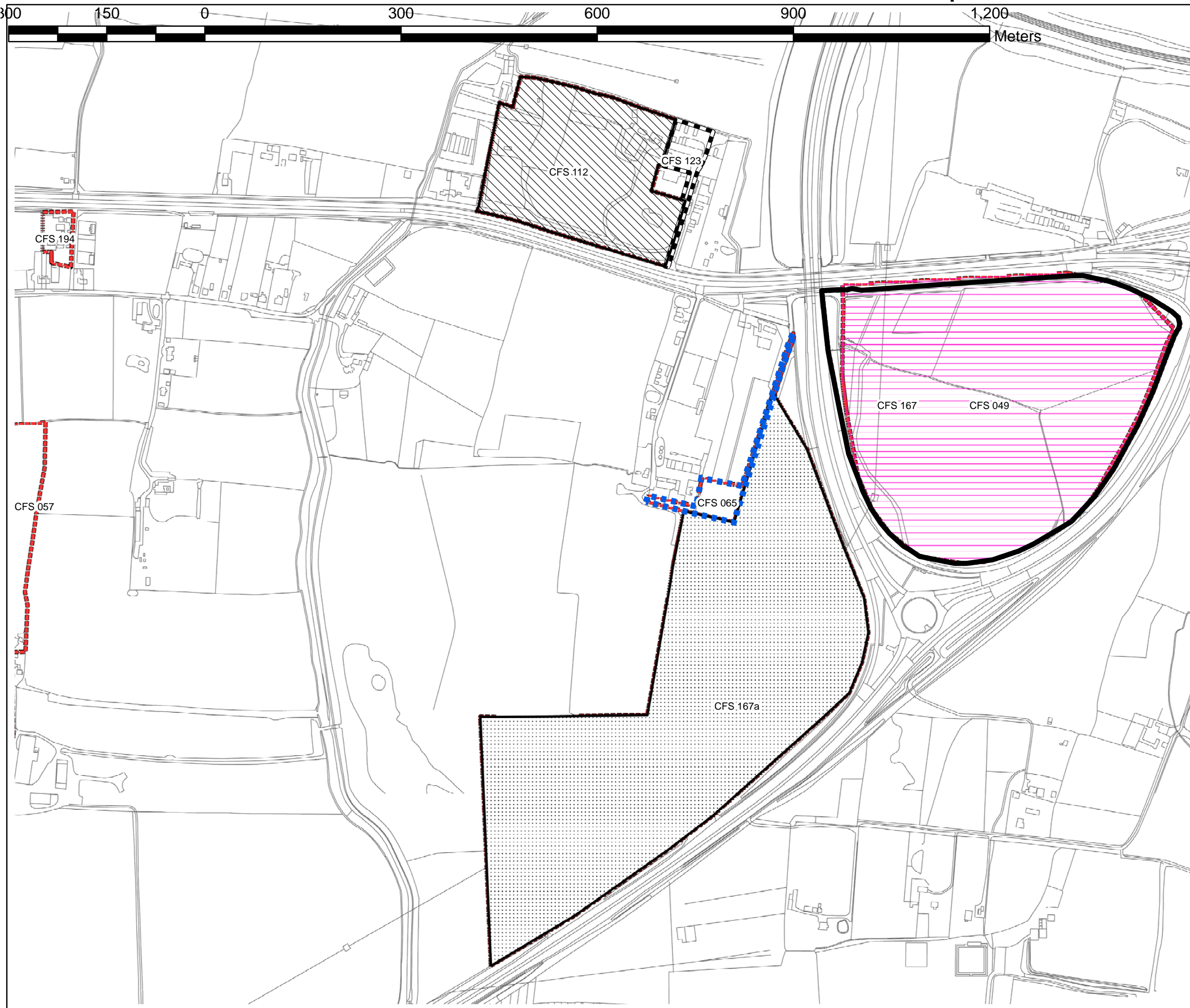

Copyright

These maps have been reproduced from Ordnance Survey material with the permission of Ordnance Survey on behalf of the Controller of Her Majesty's Stationery Office © Crown Copyright. Unauthorised reproduction infringes Crown Copyright and may lead to prosecution or civil proceedings. (DBAS200) (2008).

Sites Submitted to the Call For Sites 2007- Map 4



Legend

-  CFS 049
-  CFS 065
-  CFS 112
-  CFS 123
-  CFS 167a
-  CFS 167
-  Call for Sites - Individual Sites

Note: Due to the nature of individually submitted sites- there are often multiple Call for Sites references for roughly the same location.

This may cause some initial confusion to the user of this map.

Cross-referencing numbers to the Call for Sites Exercise will ensure that clear understanding of the submissions is gained.

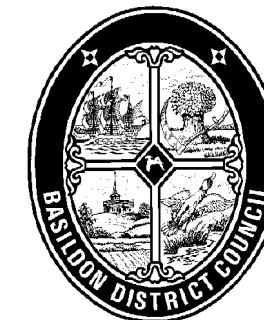

Basildon District Council
The Basildon Centre
St. Martin's Square
Basildon
Essex
SS14 1DL

This material has been reproduced from Ordnance Survey digital map data with the permission of the Controller of Her Majesty's Stationary Office - Crown Copyright 2008.